

Planning & Regulatory Manager's Report – March 2008



Dairy Stock Crossings

Crossing licences are granted for a five year period, and some are now due for renewal.

Applications to relicense have been sent out, and most returned. The new licence will be incorporated into the NCS licence system, and be issued in the same matter as other licences issued by Council.

Faecal Contamination

At the last portfolio meeting, water quality of our river swimming areas was discussed.

To increase all our general knowledge in this area, I include in this report, a brief description of coliforms and faecal streptococci, the Regional Council's annual summary report on water quality of swimming sites and some recent local water samples.

Description of E. coli and enterococci

E. coli and enterococci are members of the two bacteria groups, coliforms and faecal streptococci, respectively, and are used as indicators of possible sewage contamination because they are commonly found in human and animal faeces. Although they are generally not harmful themselves, they indicated the possible presence of pathogenic (disease-causing) bacteria, viruses, and protozoans that also live in human and animal digestive systems. Therefore, their presence in water bodies suggests that pathogenic microorganisms might also be present and that swimming and eating shellfish might be a health risk.

E. coli is relatively straightforward and inexpensive to measure. It can survive for up to four to six weeks in freshwater and is a definite indication of recent faecal contamination. While it is not possible to know whether E. coli are of human, animal or avian origin, all of these species can act as carriers of micro-organisms that can cause human disease. The chances of E. coli multiplying in water are very small, except under some specific tropical and sub-tropical conditions, so the number detected can be interpreted quantitatively.

Enterococci are distinguished by their ability to survive in salt water, and in this respect they more closely mimic many pathogens than do other indicators. Enterococci are typically more human-specific than the larger faecal streptococcus group.

Faecal coliforms are a subset of the coliform group. Although faecal coliforms are predominantly found in the intestinal tract of humans and other warm-blooded animals, they

constitute a mixed group of organisms and some of the bacteria in this group can be derived from other environmental sources. They may also multiply in water on occasions to give a false impression of faecal contamination.

Habitat of coliform bacteria

- A. Non-fecal coliforms: soil and vegetation.
- B. Fecal coliforms: animal wastes and human sewage.

Total coliform bacteria are 16 species that are found in animal wastes and human sewage.

Fecal coliform bacteria are 6 species that are found in animal wastes and human sewage.

E. coli is one of the 6 fecal coliform bacteria species, it is found in animal wastes and human sewage.

Drinking water should be 0/100ml.

Bathing water Ecan criteria should be below 260/100ml.

Emergency Management

Council CDEM has over the last report period:

- Reviewed the preparedness of the Waimate Medical Centre.
- Attended an Emergency management seminar. Topics were:
 - Emergency management planning: Lessons from recent & historical events
 - Developing effective all-hazard warning systems
 - Public education and Community engagement and public participation in building resilient communities
 - Health Sector emergency management
 - Community response and recovery
- Visit from Peter Cameron Department of Internal Affairs to discuss Civil Defence issues.
- Visit from Group Controller to discuss Civil Defence issues with Mayor, Controllers and Co-ordinator.
- Delivered Civil Defence presentation to Lister Home staff members.
- Hosted planning and coordination meeting for South Canterbury CDEM officers and District Health Board emergency planners. Discussed Pandemic Survival Roadshow,

upcoming Emergency Operations Centre courses, South Canterbury Rural Assistance Trust, Pandora exercise planning and electricity restoration priorities

- Planning and booking for Waimate District Council staff Emergency Operations Centre training initiated.
- Hosted South Canterbury District Health Board emergency planners in identifying sites for Community based assessment centres in times of medical emergencies.

Resource Consents

Since the last report, the following resource consents have been granted by the Manager: Planning and Regulatory under delegated authority:

RM080001	Subdivision – Create Two Residential Lots G. & M. Fraser 17 Opie Street, Waimate	18/02/08
RM080002	Subdivision – Create Two Rural Lots Rua Farming Company Limited 506 Glenavy-Tawai Road, Glenavy	22/02/08
RM080003	Subdivision – Create Two Rural Lots R.J. Crawford 92 Studholme Settlement Road, Waimate	25/02/08
RM080005	Land Use – Garage – Recession Line C.K. Ashton 187 Queen Street/ Hillary Street, Waimate	28/02/08

Matters of Interest:

Council has received an application for subdivision consent to create 16 residential lots varying in size from 700m² to 1069m² and a site for a reserve comprising 2309m². The site affected by this application fronts Carlisle Street, Oxford Street and Durham Street.

The site is zoned Rural in the District Plan and it is intended to connect to Council reticulated water, storm-water and sewage services. The application was publicly notified on 8 March 2008. Submissions close on 8 April 2008.

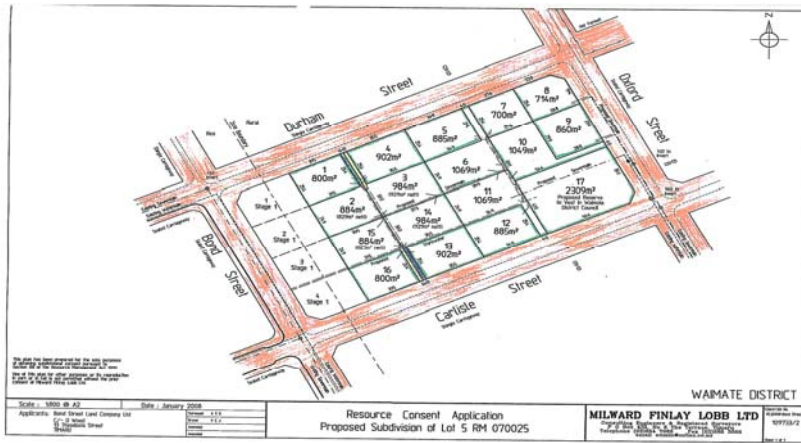

Brent Donaldson
MANAGER-PLANNING & REGULATORY

6 March 2008